

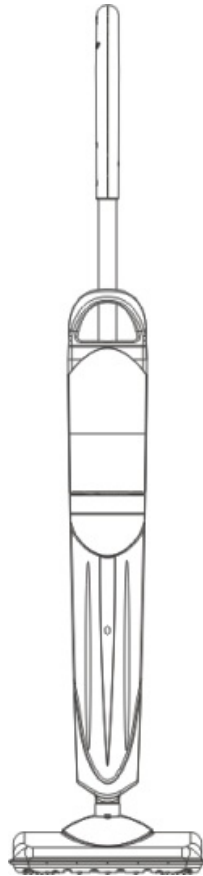

Deluxe Steam Mop

USER MANUAL



MODEL:DSC20

IMPORTANT SAFEGUARDS

When using an electric appliance, basic precautions should always be followed, including the following:

READ ALL INSTRUCTIONS BEFORE USING THIS STEAM CLEANER

WARNING: DANGER OF SCALDING

To reduce the risk of fire, electric shock, or injury:

- This product is designed for domestic use only.
- Do not use outdoors.
- Do not leave steamer unattended while turned on. Unplug the electrical cord when not in use and before servicing.
- Do not allow the steam mop to be used as a toy. Close attention is necessary when used near children, pets or plants.
- The appliance is not intended for use by young children or infirm persons.
- Young children should be supervised to ensure that they do not play with the appliance.
- Never direct steam towards people, animals, plants, or equipment containing electrical components.
- Do not immerse the steamer in water or other liquids.
- Do not use if cord or plug is damaged. If steamer is not working as it should, has been dropped, damaged, left outdoors, or immersed in water, return it to a qualified service engineer before continuing use. If the supply cord is damaged, it must be replaced by a qualified service engineer.
- Do not pull or carry by cord, use cord as a handle, close a door on the cord, or pull cord around sharp edges or corners. Keep cord away from heated surfaces.
- Do not use extension cords or outlets with inadequate current carrying capacity.
- Unplug after use. Do not unplug by pulling on cord. To unplug, grasp the plug, not the cord.
- Do not handle plug or steam cleaner with wet hands or operate without shoes.
- Do not insert any objects into openings. Do not use with any opening blocked.
- Do not use without floor cloth in place.
- Do not use on stairs.
- Store your steamer indoors in a cool, dry area.
- Keep your work area well lit.
- Never put cleaning detergents or chemical into the Steamer. This will make the operation unsafe and damage the unit.
- Use only as described in this manual. Use only manufacturer's recommended accessories.

SAVE THESE INSTRUCTIONS

KEY FEATURES OF Deluxe Steam Mop

- A) STEAMER HANDLE
- B) TRIGGER
- C) QUICK RELEASE CORD WRAP
- D) CARRY HANDLE
- E) WATER TANK
- F) SCALE FILTER
- G) STEAMER BODY
- H) POWER INDICATING LED
- I) LOWER CORD WRAP
- J) POWER CORD
- K) STEAMER HEAD
- L) CLOTH PAD
- M) CARPET GLIDER(OPTIONAL ACCESSORY)

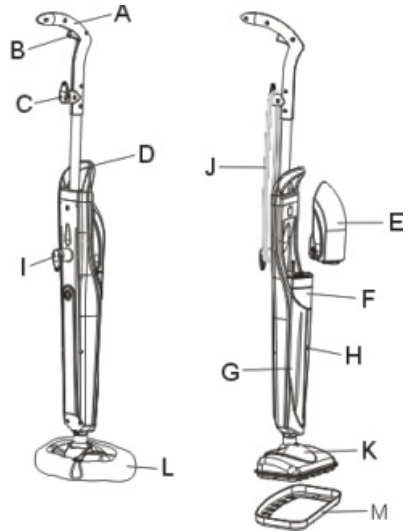

The following information is provided for service by a qualified electrician only:
Rated voltage: 220-240V, 50Hz, 1500W.

This appliance must be grounded. Use only the proper type outlet when plugging in the appliance, do not attempt to override the earth wire feature.

DESCRIPTION

Thank you and congratulations for choosing the Steam vortex floor mop. This Steamer is a modern way of cleaning that is effective and far more hygienic than conventional methods.

The Steamer achieves a high degree of hygienic and degreasing cleansing power by converting water into steam. It uses a micro fibre floor cloth to enhance absorbency. When contact is made with floor surfaces, dirt and grime can be eliminated in a matter of seconds.

Since the Steamer uses the active power of steam without the use of detergents or soap, it is environmentally friendly.

The Steamer does not require distilled water. Residents in areas with hard water can use distilled water for better performance.

When used correctly the Steamer can kill dust mites and some types of bacteria, such as salmonella and E-coli.

To disinfect a specific area, position the steamer over the area for a minimum of eight seconds. The steam temperature will reach approximately 100° C (212° F). Use this procedure to disinfect **floors** near: bathroom sanitary ware, kitchen counters, pet sleeping areas, etc.

INSTRUCTIONS FOR USE

The Steamer is designed to thoroughly clean floor surfaces, such as marble, ceramic, stone, linoleum, sealed hard wood floors and sealed laminate flooring.

WARNING: ON SURFACES THAT HAVE BEEN TREATED WITH WAX, THE WAX MAY BE REMOVED BY THE HEAT AND STEAM ACTION. DO NOT USE ON UNSEALED WOOD FLOORS OR LET UNIT STAND ON ANY WOOD FLOOR FOR AN EXTENDED PERIOD OF TIME. THIS COULD CAUSE THE WOOD GRAIN TO RISE. IT IS THEREFORE RECOMMENDED THAT A SAMPLE CLEANSING BE CARRIED OUT ON AN ISOLATED AREA OF THE FLOOR. IT IS ALSO RECOMMENDED THAT YOU CHECK THE USE AND CARE INSTRUCTIONS OF THE SURFACE FROM THE FLOOR MANUFACTURER TO ENSURE SUITABILITY TO STEAM CLEANING.

For first time use of the machine, please hold onto the switch to allow the water to get pumped to the steam chamber. The pump will make a louder noise during this initial operation.

HOW TO ASSEMBLE AND USE

- 1) Attach steamer head to steamer body.
- 2) Secure steamer head with the small Philips Head Screw until is fully tightened.

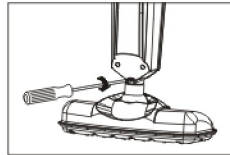
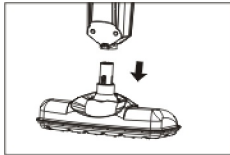

- 3) Insert steamer handle down into the steamer body.
- 4) Screw the Large Philips Head screw through the opening at the back of steamer body into the rear of the steamer handle and tighten until secure.

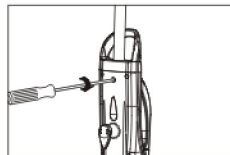
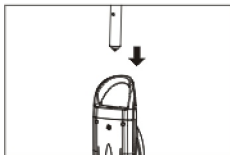

- 5) Place the steamer head in Cloth Pad, and secure the Pad by pulling the cord while pressing on Toggle.

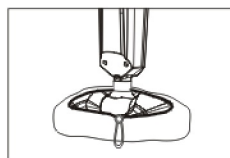
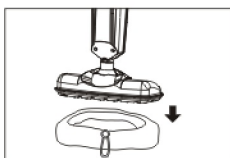

WARNING!

Do not use on velvet or dralon fabrics. If in doubt try on a small area that does not show and consult fabric manufacturers cleaning instructions.

6) Remove Water tank by lifting straight up and away from the unit. Unscrew the water tank cap and remove the insert assembly. Fill with cool tap water, and replace the insert assembly tightening the cap. Place the Water Tank on the unit.

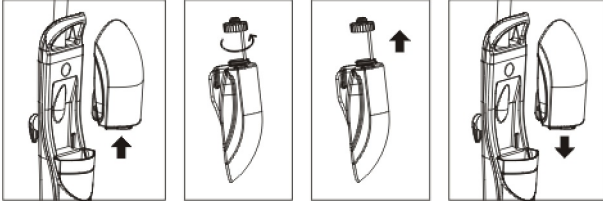

BAG CONTAINING RUBBER O RINGS.

The two large O Rings can be used to replace the two O Rings on the water tank if deemed necessary. Smear a small amount of petroleum jelly onto the O rings to aid sealing. The small O ring can be used as a replacement on the scale filter spigot.

- 7) Twist the Quick Release Cord Wrap clockwise to unwrap the Power Cord completely and plug into a power supply.
- 8) The LED will illuminate when the steamer is connected to power socket. Please wait for 20 seconds (heat up period) before pressing trigger. The steam unit is now ready for use.

NOTE: It is recommended that another high wattage appliance is not operated on the same circuit to avoid a circuit overload.

- 9) Slowly pass over surface to be cleaned while pressing trigger to emit steam. It is recommended to sweep or vacuum floor prior using the steamer.

CAUTION: TO SANITIZE AN AREA OF YOUR FLOOR, LEAVE THE STEAMER OVER THE AREA FOR A MINIMUM OF 8 SECONDS, BUT NO LONGER THAN 15 SECONDS. LEAVING THE STEAMER STATIONARY FOR A LONGER PERIOD THAN RECOMMENDED MAY CAUSE THE BUILD UP OF A PALE RESIDUE. THIS RESIDUE CAN BE REMOVED BY USING A DECALCIFYING PRODUCT OR WITH A FEW DROPS OF VINEGAR. (SEE TROUBLESHOOTING GUIDE)

WARNING: NEVER RUN THE STEAMER WITHOUT WATER. NEVER DIRECT STEAM AT ANY PERSON OR ANIMAL. USE STEAMER ON SEALED HARD FLOOR ONLY.

10) When steamer stops emitting steam, after approximately 20 minutes of use, simply remove the Water tank, refill, and continue cleaning.

11) When you finish your cleaning, unplug Power cord from outlet, empty the Water tank, carefully remove the Cloth Pad from Steamer Head, wind Power Cord around the Cord Wrap and store it upright in a dry area or hang by the storage hook.

CAUTION: THE CLOTH PAD MAY BE VERY HOT.

Instructions for use of Carpet Glider Accessory

Please ensure micro fiber cloth is attached as outlined previously.

Place carpet glider on the floor in an upright position with the triangular flat surface facing downwards.

Place Floor Steamer head on the glider as illustrated

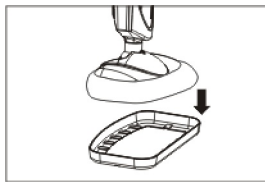

The Carpet Glider is now ready for use.

IMPORTANT

The Carpet Glider is designed **not to be fixed to the floor head** for safety reasons including the preventing burns

The carpet glider is designed **for use on soft carpeted areas only**. It is not designed for use on hard floor surfaces.

CLEANING AND MAINTENANCE

CAUTION: PRIOR TO CLEANING OR MAINTENANCE ISOLATE THE UNIT BY REMOVING THE CORD FROM THE POWER SOCKET. DO NOT IMMERSE THE UNIT IN WATER.

- 1) The micro fibre cloth can be machine washed in hot water and tumbled dry.
- 2) Wipe the steamer with a soft cloth.

The Steamer should only be used with its own specially developed floor cloths and Filter (spare Cloth Pads and Filters are available from your retailer)

TROUBLESHOOTING GUIDE

CAUTION: PRIOR TO TROUBLESHOOTING ISOLATE THE UNIT BY REMOVING THE CORD FROM THE POWER SOCKET.

PROBLEM	REMEDY
LED is not on.	Ensure Steamer power cord is correctly plugged into power outlet. Ensure circuit breaker is operational. Try operating the steamer from another power outlet.
No Steam	Ensure the water tank has correct level of water.
Pale residue left on the floor	Caused by leaving the floor steamer in the same position for too long. Can be removed with household white vinegar or a decalcifying product. Alternatively reheat the area for one minute and residue should be removed. CAUTION: Do not overheat area.

After Sales Service.

Warranty: This product is warranted to the original user for 12 months from date of purchase free from manufacturing defect at time of purchase. The product is intended for domestic use. Please keep your receipt or other evidence of purchase showing date of purchase, as this must be produced in the event of a claim.

To claim under this warranty, or for other repair or assistance with this product, please contact Domotec Customer Service Department by phoning 01844 698516.

DOMOTEC HOME APPLIANCES LIMITED. Contact
service@innovationhomeproducts.co.uk www.innovationideas.co.uk
Tel: 01844 698516

This electrical appliance complies with directive 2002/96/EC (Waste Electrical and Electronic Equipment---WEEE).



The meaning of the crossed-through waste bin symbol on the appliance is that the product must be disposed of separately to other household waste at the end of the useful life of the appliance. The user is responsible for delivering the appliance to an appropriate collection centre at that time.

Appropriate separate collection for environment-friendly treatment and recycling prevents or reduces harmful effect on the environment and human health. You can obtain information on available collection services in your area by contacting your local Council waste collection department, or the retailer from which you bought the appliance.

Domotec Home Appliances is an "Innovation Home Products Ltd" quality brand.

