

Domotec
home appliances

Steam Generator Iron

Model: DSG33

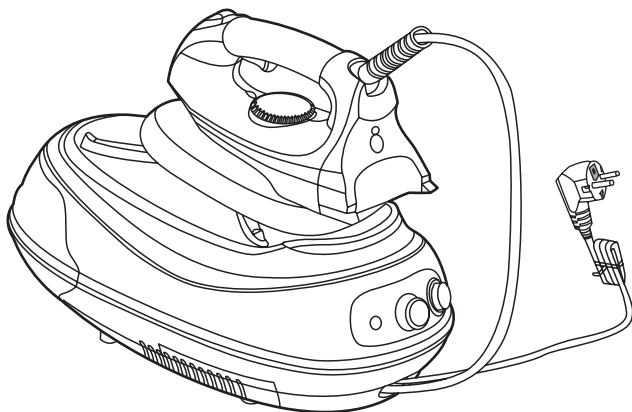

CE **RoHS**

Instruction Manual
Please Retain For Reference

IMPORTANT SAFEGUARDS

Make sure to read all the safety precautions below and look at the illustrations before you start using the appliance.

1. Read all instructions carefully before using.
2. Use the appliance for its intended use only.
3. The appliance is intended for household use only.
4. To protect against the risk of electric shock, do not immerse the iron and main base into water or any other liquids.
5. Connect the appliance only to an household ac electrical supply specified on the rating plate and only to an earthed main socket.
6. The appliance should always be turned to OFF before plugging or unplugging from outlet. Never pull cord to disconnect from outlet; instead, grasp plug and pull to disconnect.
7. Do not allow power cord or supply hose to touch hot surface.
8. Always disconnect the plug of the appliance from the main socket when filling with water or emptying and when not in use.
9. Do not operate the appliance with a damaged cord or if the appliance has been dropped or damaged. Do not disassemble the appliance, it must be taken to a qualified service engineer or manufacturer or its service agent for examination and repair. Incorrect re-assembly can cause a risk of electric shock when the iron is used.
10. Place the iron out of the reach of children, close supervision is necessary for any appliance being used by or near children. Do not leave the iron unattended while connected to the mains supply.
11. Always place the appliance on a stable, level and horizontal surface or ironing board.
12. Always place the iron on the iron rest plate horizontally. Do not put the hot iron onto the power cord or the supply hose.
13. Use and place the appliance on a stable, level and horizontal surface or ironing board.



14. Burns can occur from touching hot metal parts, hot water or steam. Use caution when using the appliance. If the iron is placed onto the iron rest plate during use, the iron rest plate may become a hot surface. Do not touch the iron rest plate and the sole-plate until they have cooled down completely.
15. Never use the iron facing towards the people because the steam can cause burns.
16. Never wind the supply hose during use.
17. To avoid a circuit overload, do not operate another high wattage appliance on the same circuit
18. If an extension cord is absolutely necessary, a 15-ampere cord should be used. Cords rated for a lower amperage may overheat, care should be taken to ensure that the cord cannot be accidentally pulled or tripped over.
19. The iron must not left unattended while it is connected to the supply mains.
20. When placing the iron be on its stand, ensure that the surface on which the stand is placed is stable.
21. The iron is not to be used if it has been dropped, if there are visible signs of damage or if it is leaking.
22. This appliance is not intended for use by persons (including children) with reduced physical, sensory or mental capabilities, or lack of experience and knowledge, unless they have been given supervision or instruction concerning use of the appliance by a person responsible for their safety.
23. Children should be supervised to ensure that they do not play with the appliance.

PARTS AND FEATURES

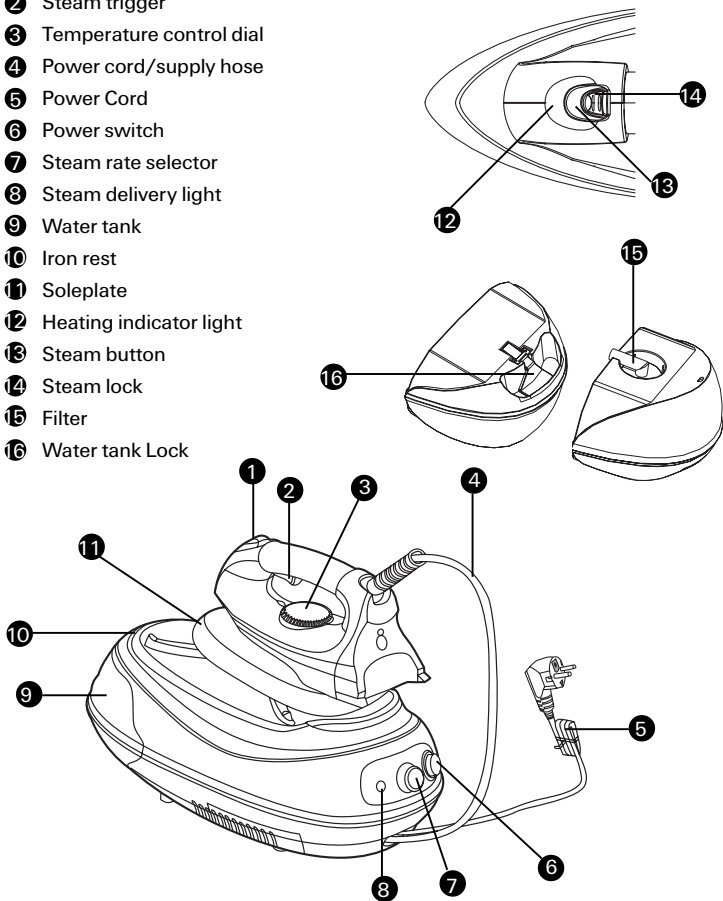
- ❶ Steam button assembly (Steam button, lock button)
- ❷ Steam trigger
- ❸ Temperature control dial
- ❹ Power cord/supply hose
- ❺ Power Cord
- ❻ Power switch
- ❼ Steam rate selector
- ❽ Steam delivery light
- ❾ Water tank
- ❿ Iron rest
- ⓫ Soleplate
- ⓬ Heating indicator light
- ⓭ Steam button
- ⓮ Steam lock
- ⓯ Filter
- ⓰ Water tank Lock



FABRIC SETTING CHART

Temperature Setting	● (Low)	●● (Medium)	●●● (MAX) / 
Fabric	Synthetics, silk, Nylon, Arcylic, Acetate	Wool, Polyester	Rayon Cotton, Linen
Ironing Instructions	Dry Iron on the opposite side of the fabric	Use a press cloth and Steam iron on the opposite side of the fabric	Iron while fabric is still damp
Steam selection Setting	Off	MIN	MIN ~ 

Ironing Temperature Setting Guide

1. Follow up the ironing instructions on the garment label. If there is not any instruction label, but you know what kind of the fabric is above, please refer to the fabric setting chart described in this instruction manual.
2. The fabric setting chart is only valid for plain fabrics and not for materials to which finishes, glosses etc, have been applied. Textile to which some kind of finish has been applied (gloss, crinkle, relief etc.) is best ironed at lower temperature.
3. First sort laundry according to ironing temperature setting guide: wool with wool, cotton with cotton, etc.
4. The iron heats up more quickly than it cools down. Therefore, start ironing articles that need to be ironed at the lowest temperature, such as those made of synthetic fibres.
5. If the fabric consists of various kinds of fibres, always select the temperature required by the most delicate fibres, i.e. the lowest temperature. for example, an article consists of 60% polyester and 40% cotton, according to the fabric setting chart it should be ironed for polyester and without steam.

6. If you do not know what kind of fabric the article is made of, iron a piece of the material which is not visible when you wear to find out the appropriate temperature for your articles.
7. Pure woollen fabrics (100% wool) should be ironed with the iron setting to steam ironing position. It is advisable to set the temperature control button to "Max" position and use a dry pressing cloth.
8. When steam ironing woollen fabrics, shiny patches may occur. You may prevent this by turning the article inside out and ironing the reverse side.
9. After ironing cotton fabrics, do not iron articles requiring lower temperature (such as nylon etc.) immediately. It is advisable to adjust the temperature button to the lower setting, waiting for about 2-6 minutes till the power indicator light turn on and then turn off, and then you can start ironing.

IMPORTANT HINTS

Do not fill water tank with vinegar, perfume, starch, chemically descaled water or descaling agents, THIS WILL INVALIDATE THE WARRANTY.

Prepare the appliance for use

1. Check if the voltage indicated in the rating plate corresponding to the main voltage in your home.
2. Fully unwind and straighten the power cord and the supply hose.
3. Place the appliance on a stable, level and horizontal surface such as ironing board.
4. Iron should be well placed on iron rest, (shown as Fig.A) do not allow its soleplate touch iron rest. (shown as Fig.B)

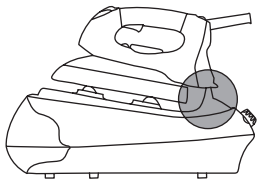

Fig.A

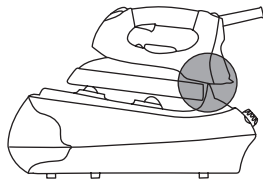
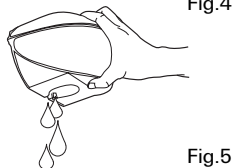
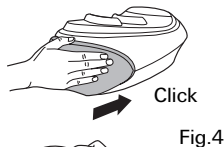
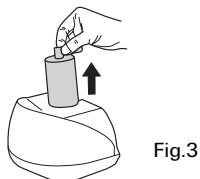
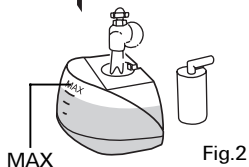
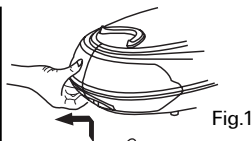

Fig.B

Fill Water Tank

1. Press upwards the release button at the water tank and slide the detachable water tank outwards from the base. (See Fig.1)
2. Fill the water tank up to or below the "MAX" fill line with the clean tap water. (See Fig.2) (You can take filter out of the opening for filling water into water tank, (See Fig.3) or fill water into water tank directly with the filter existing in the opening. When empty the water tank will take 1 litre of water.
3. When empty the water tank will take one litre of water replace the water tank into the base unit again. It will be locked in place with the base unit when a "click" sound is heard. (See Fig.4)
4. Always pour out the remaining water after use. (See Fig.5)

Note: When the water level reaches a low level or empty, pump will provide sound to indicate refilling. Stop using the appliance immediately and refill water tank using the methods mentioned above.



Steam function setting

After power on, if steam is necessary, set temperature control dial to steam ironing position according to fabric setting chart. When temperature control dial is set at "●●●" or "Max" position. Steam adjustable knob should be set at "MIN" ~ "🌀" range. When temperature control dial is set at "●●", steam adjustable knob should be set at "MIN" position. If water leakage happens

during use, set temperature control dial at higher temperature position or steam adjustable knob to lower position. When temperature control dial set at " ● ", do not use steam ironing, otherwise, water leakage will happen from soleplate. Steam ironing cannot be activated until heating indicator light turns off.

Steam ironing

1. Fill the water tank with clean tap water refer to above filling instructions. **(Note:** For every first use of the filter, please immerse it in water for better performance)
2. An empty tank will accept one litre of water, connect the appliance into suitable socket outlet. Press the power switch at base control panel until power indicator light turns on to show the connection of the power supply.
3. Set temperature control dial at the steam ironing setting according to fabric setting chart. The temperature indicator light comes ON to indicate the iron being heated up(Refer to image), when temperature indicator light OFF ,the required temperature has been reached, the unit is ready for use. During use, it is normal that the temperature indicator light will cycle from ON to OFF and then OFF to ON.This shows that steam chamber automatically keeps temperature constant.
4. Before every first use, the iron should be cleaned using following procedure: Select adjustable steam knob to Max steam setting, hold the iron and press the steam switch underneath the handle for 20 seconds, and then release for 30 seconds, do this for two cycles. When heating indicator light OFF, it is ready for ironing. This process ensures optimal performance of the iron throughout its life.
5. During steam ironing, adjust steam rate according to requirements based on above steam function setting
6. After use, turn temperature control dial to "MIN" ,put iron back onto base unit, Switch off the unit by pressing the power switch and then unplug the appliance from the outlet.

7. Take water tank out of the base unit and pour out remaining water from water tank.

NOTES:

- a. For every first time use, it is normal that a slight vibration sound may be heard from electrical pump inside the base unit for a few seconds when steam ironing is started. It is because the water is being pumped into the heating chamber. If this happens for more than 30 seconds, please check whether water tank and filter assembled correctly or not.
- b. Every first time use, please set adjustable steam knob to Max position to allow steam escape quickly

Dry Ironing

1. Connect the appliance to a suitable socket outlet. Press the power switch at base control panel until power indicator light turns ON to show the connection of the power supply.
2. Turn steam control dial at the iron to desired position according to fabric setting chart, The iron's red light will go on to indicate the iron being heated up. It will go off when the required temperature is reached. During the dry ironing stage, the temperature indicator will cycle from ON to OFF and then OFF to ON automatically because the iron is automatically maintaining sole plate temperature.
3. After use, turn the temperature control dial to "MIN" position. Then, turn off the power switch and unplug the appliance from the outlet.

Note:

When changing your Temp setting from high setting to lower, not to start ironing immediately as your fabrics may be burnt by the by high temperature. The unit should not be used until temperature indicator light on iron unit ON . Otherwise burns will be caused to your fabrics.

Vertical steam ironing

Follow the steam ironing process, and then hold the iron in vertical position between 5cm and 15cm away from the hanging fabrics. Press down steam switch, this will create vertical steam. This feature is especially used for removing creases from hanging clothes and curtains. Never directly perform steam ironing on people. (See Fig.6)

NOTE: During vertical steam ironing, hold the iron in a less than 90° angle from vertical position. Do not use the appliance continuously for more than 2 minutes. Otherwise, water dripping will happen.

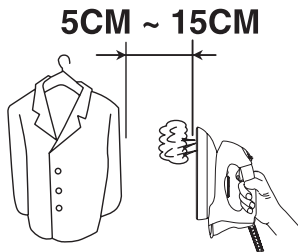

Fig.6

Steam button auto lock function

If long time steam ironing is needed, please press down lock button and then push it backward, steam button will automatically lock. Steam will escape continuously. If you want to stop steam escaping, please push lock button forward.

Notice: When steam button auto lock function is activated, users can not leave steam appliance unattended. During steam ironing, if water has been used up, pump will provide sound to indicate refill. Please unlock lock button and refill again.

Pump overheat protection function

Overheat protection equipment installed in pump. When water in water tank

has been used up. Pump will be hot, and when temperature of pump being heated up exceeds its' Max limit, overheat protection will automatically activate to protect pump being damaged. At this moment, steam delivery indicator light will turn off, please turn power switch on base unit off at first ,and then check if water tank has sufficient water or water tank has been well assembled. If not, please refill water tank and re-assemble water tank well into base unit. 30 minutes later, it will re-work again.

Replacement of Filter

- Follow below procedure to replace the filter:
 - i. Slide out the water tank from the base,(See Fig.7) and then take out the filter from the water tank. (See Fig.8)
 - ii. Replace it with a new one.
 - iii. Re-install it into the water tank. (See Fig.9)
 - iv. Fill water into water tank up to MAX fill level,(See Fig.10)and slide water tank into the power base again. (See Fig.11)

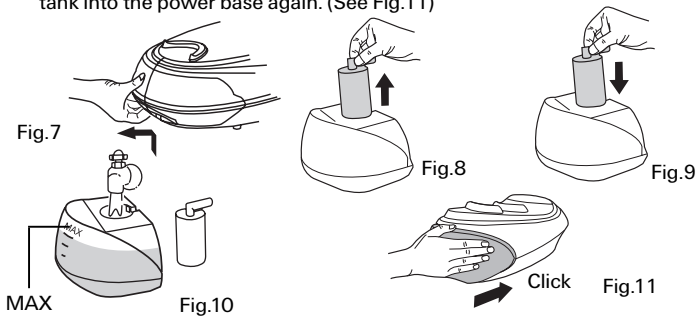

Anti-Scale system

1. Filter is designed to reduce the build-up of limescale which occurs during steam ironing, this will prolong the working life of your iron. However, please note that the filter will not completely stop the natural process of limescale build-up.

2. Filter should be replaced with a new one after about 2 months' use.(base: 1. OL / times x 2 times / week) Working life of filter depends on local water you used. If working life exceed its Max limit, the appliance can be used continuously, but limescale will be built up in steam chamber. So you should replace the filter as soon as possible or mix your tap water with distilled water at a proportion of 50%,if your local water is hard .

Emptying and storing

1. After use, slide out the water tank and pour out all the remaining water. (See Fig.12)
2. Disconnect the appliance from the power supply and allow the appliance to cool down for 60 minutes at least.
3. The iron should be placed on the iron rest plate of the power base and they should be stored together.

Cleaning and Maintenance

1. Unplug the appliance from the main supply and let the iron cool down.
2. Clean the iron with a damp cloth. (See Fig.13)
3. Wipe off scale and any other deposits on the soleplate with a damp cloth or non-brasive(liquid) cleaner.
4. Never clean the appliance under the tap.
5. Since steam vents are small, to prevent steam vents being blocked by limescale, please clean steam vents with a ϕ 1.5mm steel pin after every 3-5 monthes's use.(See Fig.14)

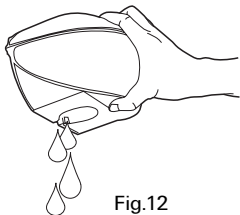

Fig.12

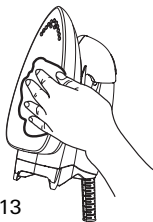

Fig.13

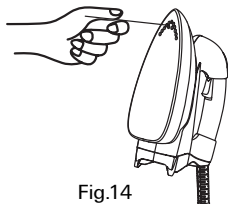

Fig.14

Trouble Shooting Guide

Problems	Possible causes	Solution
Iron won't heat	The appliance has not been plugged into power supply	Connect the appliance to power supply.
	The temperature control button is set at "Min" position.	Select the required ironing temperature as indicated in the temperature guide table.
	The appliance has not been switched on	Switch appliance on by pressing the power switch button at the base
	Any unknown factor	Stop use and take the appliance to manufacturer or its service agent for examination
The appliance does not produce steam	The water tank is empty	Refill the water tank
	Filter has not been placed in water tank.	Assemble filter into water tank
	Water tank has not been correctly assembled.	Pull water tank out and then insert it back into base unit, it locks in place until a "click" sound is heard.
	Adjustable steam knob set at "MIN"	Set adjustable steam knob to MAX
	Pump overheat protection	Allow it cool down for 30 minutes
Droplets of water escape from the soleplate	During steam ironing, temperature control dial set at a too low temperature position for steam ironing	Select the required temperature according to fabric setting chart.
	Desired temperature has not been reached	It is ready for use when heating indicator light on base unit turn off.
	Adjustable steam knob set too high	Set adjust steam knob to the lower position

After Sales Service.

Warranty: This product is warranted to the original user for 12 months from date of purchase free from manufacturing defect at time of purchase. The product is intended for domestic use. Please keep your receipt or other evidence of purchase showing date of purchase, as this must be produced in the event of a claim.

To claim under this warranty, or for other repair or assistance with this product, please contact Innovation Home Products Ltd Service Department by phoning 01844 698516, or by e-mail service@innovationhomeproducts.co.uk

Innovation Home Products Ltd. Registered Office. Temple House, 9 The Vines. Shabbington. Buckinghamshire. HP18 9HH

Disposal Of Electrical Waste.

This electrical appliance complies with directive 2002/96/EC (Waste Electrical and Electronic Equipment---WEEE). Our membership number WEE/MP3538PZ/SCH



The meaning of the crossed-through waste bin symbol on the appliance is that the product must be disposed of separately to other household waste at the end of the useful life of the appliance. The user is responsible for delivering the appliance to an appropriate collection centre at that time. Appropriate separate collection for environment-friendly treatment and recycling prevents or reduces harmful effect on the environment and human health. You can obtain information on available collection services in your area by contacting your local Council waste collection department, or the retailer from which you bought the appliance.

www.domotec.uk.com

Domotec
home appliances

Domotec a quality brand

from **innovation**

WARNING - This appliance must be earthed. This appliance may be fitted with a non rewirable plug. If it is necessary to change the fuse in a non rewirable plug the fuse cover must be refitted. If the fuse cover is lost or damaged, the plug must not be used until a replacement, available from the appliance manufacturer, is obtained. It is important that the colour of the replacement fuse cover corresponds with the colour marking on the base of the plug. If the plug requires to be changed because it is not suitable for your socket, or becomes damaged, it should be cut off and an appropriate plug fitted following the wiring instruction (below). the plug removed must be disposed of safely as insertion into a 13A socket is likely to cause an electrical hazard.

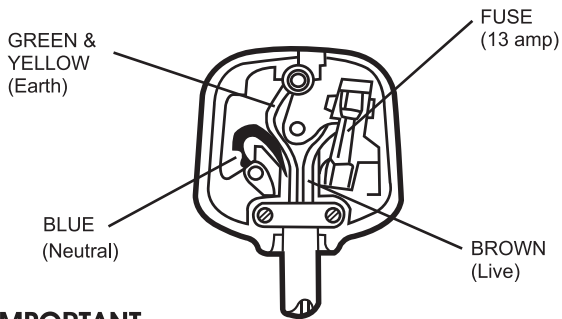

IMPORTANT

This wires in this mains lead are coloured in accordance with the following code.

- Green - and yellow : Earth
- Blue: Neutral
- Brown: Live

As the colours of the wires in the mains leads of this appliances may not correspond, with the coloured markings identifying the terminals in your plug, proceed as follows: The wire which is coloured green - and yellow must be connected to the terminal in the plug which is marked with the letter "E" or by the earth symbol or green - and - yellow. The wire which is coloured blue must be connected to the terminal which is marked with the letter "N" or coloured black. The wire which is coloured brown must be connected to the terminal which is marked with the Letter "L" or coloured red.